

Werkzeughalter VDI - DIN 69880



- Werkzeughalter DIN 69880
- Stangengreifer
- Mitlaufende Zentrierspitzen
- Reduzierbuchsen
- Prüfdorne
- Schutzstopfen



Watermunt 178
NL - 5931 TL Tegelen
T +31 (0)77 3260124

info@technotool.nl
www.technotool.nl
M +31(0) 6 2002 4242

Einsatz von Axial-Werkzeughaltern bei linker Spindeldrehrichtung

Application of axial tool holders with left-hand spindle rotation

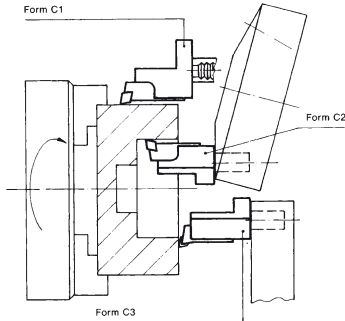

Einsatz von Axial-Werkzeughaltern bei rechter Spindeldrehrichtung

Application of axial tool holders with right-hand spindle rotation

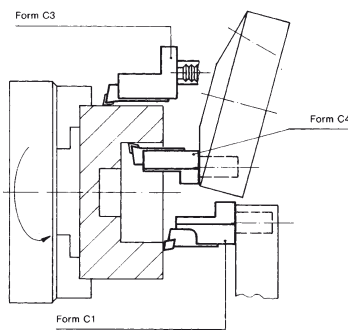

Einsatz von Radial-Werkzeughaltern bei linker Spindeldrehrichtung

Application of radial tool holders with left-hand spindle rotation

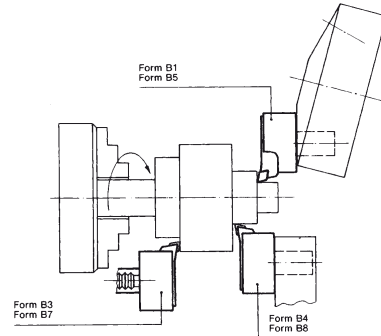

Einsatz von Radial-Werkzeughaltern bei rechter Spindeldrehrichtung

Application of radial tool holders with right-hand spindle rotation

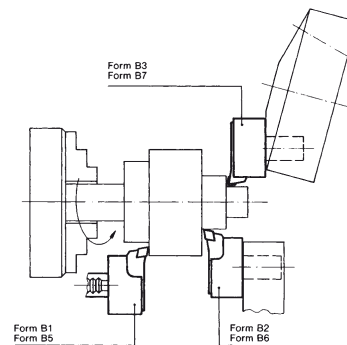

Typ A1, Werkzeughalter-Rohling, rechteckig*

Type A1, rectangular soft blank*

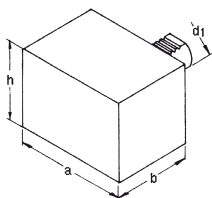

| d1 mm | a mm | h mm | b mm | | Art.-Nr./ Order no |
|----------|---------|---------|---------|---|-----------------------|
| 16 | 78 | 44 | 44 | ● | 47-A1-16-44 |
| 20 | 100 | 60 | 65 | ● | 47-A1-20-65 |
| 25 | 100 | 60 | 75 | ● | 47-A1-25-75 |
| 30 | 130 | 76 | 85 | ● | 47-A1-30-85 |
| 40 | 151 | 96 | 100 | ● | 47-A1-40-100 |
| 50 | 160 | 120 | 125 | ● | 47-A1-50-125 |
| 60 | 165 | 125 | 160 | ● | 47-A1-60-160 |

* Rohlinge sind aus Material 41 Cr 4 (1.7035)

* Blanks are from material 41 Cr 4 (1.7035)

Typ A2, Werkzeughalter-Rohling, rund*
Type A2, round soft blank*

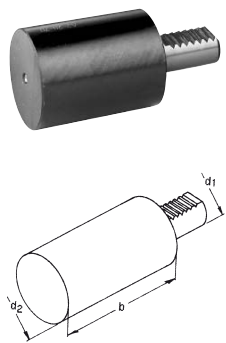

| d1 mm | d2 mm | b mm | | Art.-Nr./ Order no |
|----------|----------|---------|---|-----------------------|
| 16 | 40 | 60 | ● | 47-A2-16-60 |
| 20 | 50 | 70 | ● | 47-A2-20-70 |
| 25 | 58 | 80 | ● | 47-A2-25-80 |
| 30 | 68 | 100 | ● | 47-A2-30-100 |
| 30 | 68 | 240 | ● | 47-A2-30-240 |
| 40 | 83 | 120 | ● | 47-A2-40-120 |
| 40 | 83 | 320 | ● | 47-A2-40-320 |
| 50 | 98 | 135 | ● | 47-A2-50-135 |
| 50 | 98 | 400 | ● | 47-A2-50-400 |
| 60 | 123 | 150 | ● | 47-A2-60-150 |
| 60 | 123 | 480 | ● | 47-A2-60-480 |

* Rohlinge sind aus Material 41 Cr 4 (1.7035)

* Blanks are from material 41 Cr 4 (1.7035)

Typ B1, Radial-Werkzeughalter, rechts, kurz
Type B1, radial tool holder, right-hand, short

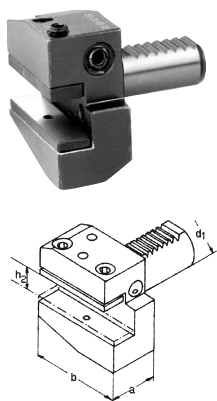

| d1 mm | h2 mm | a mm | b mm | | Art.-Nr./ Order no |
|----------|----------|---------|---------|---|-----------------------|
| 16 | 10/12 | 24 | 42 | ● | 47-B1-16-12 |
| 20 | 12/16 | 30 | 55 | ● | 47-B1-20-16 |
| 25 | 12/16 | 30 | 55 | ● | 47-B1-25-16 |
| 30 | 16/20 | 40 | 70 | ● | 47-B1-30-20 |
| 40 | 20/25 | 44 | 85 | ● | 47-B1-40-25 |
| 50 | 25/32 | 55 | 100 | ● | 47-B1-50-32 |
| 60 | 25/32 | 60 | 125 | ● | 47-B1-60-32 |

Typ B2, Radial-Werkzeughalter, links, kurz
Type B2, radial tool holder, left-hand, short

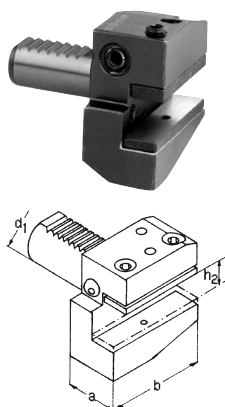

| d1 mm | h2 mm | a mm | b mm | | Art.-Nr./ Order no |
|----------|----------|---------|---------|---|-----------------------|
| 16 | 10/12 | 24 | 42 | ● | 47-B2-16-12 |
| 20 | 12/16 | 30 | 55 | ● | 47-B2-20-16 |
| 25 | 12/16 | 30 | 55 | ● | 47-B2-25-16 |
| 30 | 16/20 | 40 | 70 | ● | 47-B2-30-20 |
| 40 | 20/25 | 44 | 85 | ● | 47-B2-40-25 |
| 50 | 25/32 | 55 | 100 | ● | 47-B2-50-32 |
| 60 | 25/32 | 60 | 125 | ● | 47-B2-60-32 |

Typ B3, Radial-Werkzeughalter, überkopf, rechts, kurz
Type B3, radial tool holder, inverted, right-hand, short

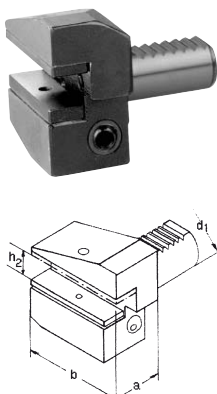

| d1 mm | h2 mm | a mm | b mm | | Art.-Nr./ Order no |
|----------|----------|---------|---------|---|-----------------------|
| 16 | 10/12 | 24 | 42 | ● | 47-B3-16-12 |
| 20 | 12/16 | 30 | 55 | ● | 47-B3-20-16 |
| 25 | 12/16 | 30 | 55 | ● | 47-B3-25-16 |
| 30 | 16/20 | 40 | 70 | ● | 47-B3-30-20 |
| 40 | 20/25 | 44 | 85 | ● | 47-B3-40-25 |
| 50 | 25/32 | 55 | 100 | ● | 47-B3-50-32 |
| 60 | 25/32 | 60 | 125 | ● | 47-B3-60-32 |

VDI-Halter
VDI-Tool holders

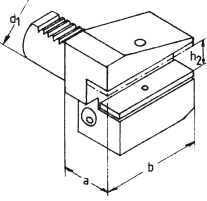

Typ B4, Radial-Werkzeughalter, überkopf, links, kurz
Type B4, radial tool holder, inverted, left-hand, short

| d1 mm | h2 mm | a mm | b mm | | Art.-Nr./ Order no |
|----------|----------|---------|---------|---|-----------------------|
| 16 | 10/12 | 24 | 42 | ● | 47-B4-16-12 |
| 20 | 12/16 | 30 | 55 | ● | 47-B4-20-16 |
| 25 | 12/16 | 30 | 55 | ● | 47-B4-25-16 |
| 30 | 16/20 | 40 | 70 | ● | 47-B4-30-20 |
| 40 | 20/25 | 44 | 85 | ● | 47-B4-40-25 |
| 50 | 25/32 | 55 | 100 | ● | 47-B4-50-32 |
| 60 | 25/32 | 60 | 125 | ● | 47-B4-60-32 |

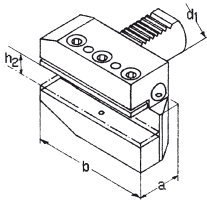

Typ B5, Radial-Werkzeughalter, rechts, lang
Type B5, radial tool holder, right-hand, long

| d1 mm | h2 mm | a mm | b mm | | Art.-Nr./ Order no |
|----------|----------|---------|---------|---|-----------------------|
| 16 | 10/12 | 24 | 58 | ● | 47-B5-16-12 |
| 20 | 12/16 | 30 | 75 | ● | 47-B5-20-16 |
| 25 | 12/16 | 30 | 75 | ● | 47-B5-25-16 |
| 30 | 16/20 | 40 | 100 | ● | 47-B5-30-20 |
| 40 | 20/25 | 44 | 118 | ● | 47-B5-40-25 |
| 50 | 25/32 | 55 | 130 | ● | 47-B5-50-32 |
| 60 | 25/32 | 60 | 145 | ● | 47-B5-60-32 |

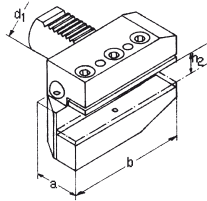

Typ B6, Radial-Werkzeughalter, links, lang
Type B6, radial tool holder, left-hand, long

| d1 mm | h2 mm | a mm | b mm | | Art.-Nr./ Order no |
|----------|----------|---------|---------|---|-----------------------|
| 16 | 10/12 | 24 | 58 | ● | 47-B6-16-12 |
| 20 | 12/16 | 30 | 75 | ● | 47-B6-20-16 |
| 25 | 12/16 | 30 | 75 | ● | 47-B6-25-16 |
| 30 | 16/20 | 40 | 100 | ● | 47-B6-30-20 |
| 40 | 20/25 | 44 | 118 | ● | 47-B6-40-25 |
| 50 | 25/32 | 55 | 130 | ● | 47-B6-50-32 |
| 60 | 25/32 | 60 | 145 | ● | 47-B6-60-32 |

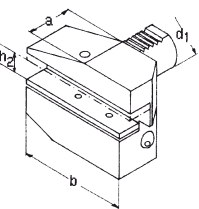

Typ B7, Radial-Werkzeughalter, überkopf, rechts, lang
Type B7, radial tool holder, inverted, right-hand, long

| d1 mm | h2 mm | a mm | b mm | | Art.-Nr./ Order no |
|----------|----------|---------|---------|---|-----------------------|
| 16 | 10/12 | 24 | 58 | ● | 47-B7-16-12 |
| 20 | 12/16 | 30 | 75 | ● | 47-B7-20-16 |
| 25 | 12/16 | 30 | 75 | ● | 47-B7-25-16 |
| 30 | 16/20 | 40 | 100 | ● | 47-B7-30-20 |
| 40 | 20/25 | 44 | 118 | ● | 47-B7-40-25 |
| 50 | 25/32 | 55 | 130 | ● | 47-B7-50-32 |
| 60 | 25/32 | 60 | 145 | ● | 47-B7-60-32 |

VDI-Halter
VDI-Tool holders

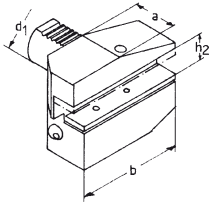

Typ B8, Radial-Werkzeughalter, überkopf, links, lang
Type B8, radial tool holder, inverted, left-hand, long

| d1 mm | h2 mm | a mm | b mm | Art.-Nr./ Order no |
|-------|-------|------|------|--------------------|
| 16 | 10/12 | 24 | 58 | 47-B8-16-12 |
| 20 | 12/16 | 30 | 75 | 47-B8-20-16 |
| 25 | 12/16 | 30 | 75 | 47-B8-25-16 |
| 30 | 16/20 | 40 | 100 | 47-B8-30-20 |
| 40 | 20/25 | 44 | 118 | 47-B8-40-25 |
| 50 | 25/32 | 55 | 130 | 47-B8-50-32 |
| 60 | 25/32 | 60 | 145 | 47-B8-60-32 |

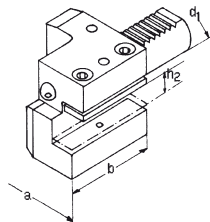

Typ C1, Axial-Werkzeughalter, rechts
Type C1, axial tool holder, right-hand

| d1 mm | h2 mm | b mm | a mm | Art.-Nr./ Order no |
|-------|-------|------|------|--------------------|
| 16 | 10/12 | 44 | 43 | 47-C1-16-12 |
| 20 | 12/16 | 50 | 52 | 47-C1-20-16 |
| 25 | 12/16 | 55 | 58 | 47-C1-25-16 |
| 30 | 16/20 | 70 | 76 | 47-C1-30-20 |
| 40 | 20/25 | 85 | 85 | 47-C1-40-25 |
| 50 | 25/32 | 100 | 100 | 47-C1-50-32 |
| 60 | 25/32 | 125 | 125 | 47-C1-60-32 |

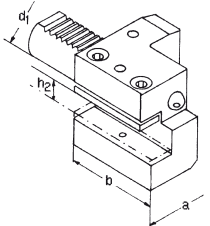

Typ C2, Axial-Werkzeughalter, links
Type C2, axial tool holder, left-hand

| d1 mm | h2 mm | b mm | a mm | Art.-Nr./ Order no |
|-------|-------|------|------|--------------------|
| 16 | 10/12 | 44 | 43 | 47-C2-16-12 |
| 20 | 12/16 | 50 | 52 | 47-C2-20-16 |
| 25 | 12/16 | 55 | 58 | 47-C2-25-16 |
| 30 | 16/20 | 70 | 76 | 47-C2-30-20 |
| 40 | 20/25 | 85 | 85 | 47-C2-40-25 |
| 50 | 25/32 | 100 | 100 | 47-C2-50-32 |
| 60 | 25/32 | 125 | 125 | 47-C2-60-32 |

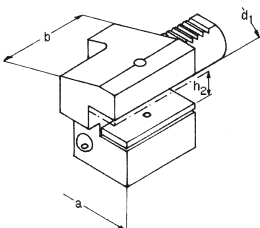

Typ C3, Axial-Werkzeughalter, überkopf, rechts
Type C3, axial tool holder, inverted, right-hand

| d1 mm | h2 mm | b mm | a mm | Art.-Nr./ Order no |
|-------|-------|------|------|--------------------|
| 16 | 10/12 | 44 | 43 | 47-C3-16-12 |
| 20 | 12/16 | 50 | 52 | 47-C3-20-16 |
| 25 | 12/16 | 55 | 58 | 47-C3-25-16 |
| 30 | 16/20 | 70 | 76 | 47-C3-30-20 |
| 40 | 20/25 | 85 | 85 | 47-C3-40-25 |
| 50 | 25/32 | 100 | 100 | 47-C3-50-32 |
| 60 | 25/32 | 125 | 125 | 47-C3-60-32 |

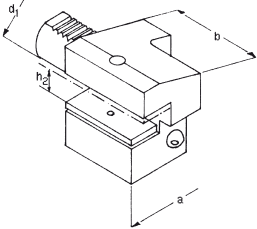

Typ C4, Axial-Werkzeughalter, überkopf, links
Type C4, axial tool holder, inverted, left-hand

| d1 mm | h2 mm | b mm | a mm | | Art.-Nr./ Order no |
|----------|----------|---------|---------|---|-----------------------|
| 16 | 10/12 | 44 | 43 | ● | 47-C4-16-12 |
| 20 | 12/16 | 50 | 52 | ● | 47-C4-20-16 |
| 25 | 12/16 | 55 | 58 | ● | 47-C4-25-16 |
| 30 | 16/20 | 70 | 76 | ● | 47-C4-30-20 |
| 40 | 20/25 | 85 | 85 | ● | 47-C4-40-25 |
| 50 | 25/32 | 100 | 100 | ● | 47-C4-50-32 |
| 60 | 25/32 | 125 | 125 | ● | 47-C4-60-32 |



Typ D1, Vierkant-Mehrfach-Aufnahme
Type D1, multiple square tool holder

| d1 mm | h2 mm | b mm | a mm | | Art.-Nr./ Order no |
|----------|----------|---------|---------|---|-----------------------|
| 25 | 12/16 | 48 | 66 | ● | 47-D1-25-16 |
| 30 | 16/20 | 60 | 76 | ● | 47-D1-30-20 |
| 40 | 20/25 | 72 | 90 | ● | 47-D1-40-25 |
| 50 | 25/32 | 85 | 105 | ● | 47-D1-50-32 |



Typ D2, Vierkant-Mehrfach-Aufnahme, überkopf
Type D2, multiple square tool holder, inverted

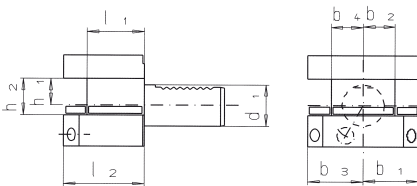

| d1 mm | h1/h2 mm | b mm | a mm | | Art.-Nr./ Order no |
|----------|-------------|---------|---------|---|-----------------------|
| 25 | 12/16 | 48 | 66 | ● | 47-D2-25-16 |
| 30 | 16/20 | 60 | 76 | ● | 47-D2-30-20 |
| 40 | 20/25 | 72 | 90 | ● | 47-D2-40-25 |
| 50 | 25/32 | 85 | 105 | ● | 47-D2-50-32 |

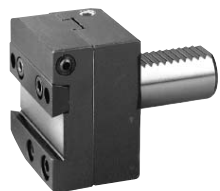

Abstechhalter, rechts
Parting off tool holder, right-hand

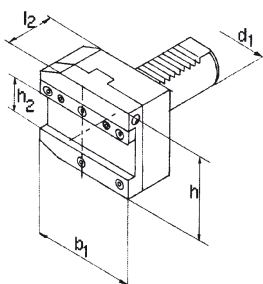

| d1 mm | b1 mm | h mm | l2 mm | h2 mm | | Art.-Nr./ Order no |
|----------|----------|---------|----------|----------|---|-----------------------|
| 30 | 70 | 70 | 50 | 26 | ● | 47-AR-3026 |
| 40 | 85 | 78 | 50 | 26 | ● | 47-AR-4032 |
| 50 | 100 | 80 | 50 | 32 | ● | 47-AR-5032 |

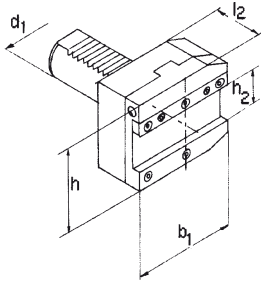

Abstechhalter, links
Parting off tool holder, left-hand

| d1 mm | b1 mm | h mm | l2 mm | h2 mm | | Art.-Nr./ Order no |
|----------|----------|---------|----------|----------|---|-----------------------|
| 30 | 70 | 70 | 50 | 26 | ● | 47-AL-3026 |
| 40 | 85 | 78 | 50 | 26 | ● | 47-AL-4032 |
| 50 | 100 | 80 | 50 | 32 | ● | 47-AL-5032 |

Typ E1, Wendepplatten-Bohrerhalter, IK
Type E1, U-drill holder, IC

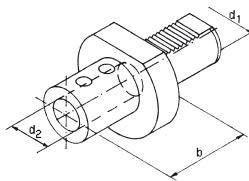

| d1 mm | d2 mm | b mm | | Art.-Nr./ Order no |
|----------|----------|---------|---|-----------------------|
| 20 | 16 | 66 | ● | 47-E1-20-16 |
| 20 | 20 | 67 | ● | 47-E1-20-20 |
| 20 | 25 | 71 | ● | 47-E1-20-25 |
| 25 | 20 | 67 | ● | 47-E1-25-20 |
| 25 | 25 | 71 | ● | 47-E1-25-25 |
| 30 | 10 | 66 | ● | 47-E1-30-10 |
| 30 | 12 | 66 | ● | 47-E1-30-12 |
| 30 | 16 | 66 | ● | 47-E1-30-16 |
| 30 | 20 | 67 | ● | 47-E1-30-20 |
| 30 | 25 | 71 | ● | 47-E1-30-25 |
| 30 | 32 | 75 | ● | 47-E1-30-32 |
| 40 | 10 | 66 | ● | 47-E1-40-10 |
| 40 | 12 | 66 | ● | 47-E1-40-12 |
| 40 | 16 | 66 | ● | 47-E1-40-16 |
| 40 | 20 | 67 | ● | 47-E1-40-20 |
| 40 | 25 | 75 | ● | 47-E1-40-25 |
| 40 | 32 | 75 | ● | 47-E1-40-32 |
| 40 | 40 | 90 | ● | 47-E1-40-40 |
| 40 | 50 | 100 | ● | 47-E1-40-50 |
| 50 | 10 | 67 | ● | 47-E1-50-10 |
| 50 | 12 | 67 | ● | 47-E1-50-12 |
| 50 | 16 | 67 | ● | 47-E1-50-16 |
| 50 | 20 | 67 | ● | 47-E1-50-20 |
| 50 | 25 | 80 | ● | 47-E1-50-25 |
| 50 | 32 | 80 | ● | 47-E1-50-32 |
| 50 | 40 | 90 | ● | 47-E1-50-40 |
| 50 | 50 | 100 | ● | 47-E1-50-50 |
| 60 | 10 | 80 | ● | 47-E1-60-10 |
| 60 | 12 | 80 | ● | 47-E1-60-12 |
| 60 | 16 | 80 | ● | 47-E1-60-16 |
| 60 | 20 | 80 | ● | 47-E1-60-20 |
| 60 | 25 | 80 | ● | 47-E1-60-25 |
| 60 | 32 | 80 | ● | 47-E1-60-32 |
| 60 | 40 | 90 | ● | 47-E1-60-40 |
| 60 | 50 | 100 | ● | 47-E1-60-50 |

**Beliebige Innendurchmesser, Zwischengrößen, Zollmaße etc.
lieferbar auf Anfrage!**

**Any internal diameter, intermediary bores, inch bores etc.
available upon request!**

Typ E2, Bohrstangenhalter, IK/EK
Type E2, boring bar holder, IC/EC

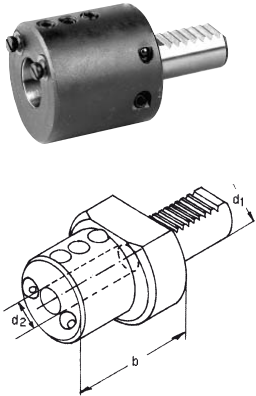

| d1 mm | d2 mm | b mm | | Art.-Nr./ Order no |
|----------|----------|---------|---|-----------------------|
| 16 | 6 | 44 | ● | 47-E2-16-06 |
| 16 | 8 | 44 | ● | 47-E2-16-08 |
| 16 | 10 | 44 | ● | 47-E2-16-10 |
| 16 | 12 | 44 | ● | 47-E2-16-12 |
| 16 | 16 | 44 | ● | 47-E2-16-16 |
| 20 | 8 | 50 | ● | 47-E2-20-08 |
| 20 | 10 | 50 | ● | 47-E2-20-10 |
| 20 | 12 | 50 | ● | 47-E2-20-12 |
| 20 | 16 | 50 | ● | 47-E2-20-16 |
| 20 | 20 | 50 | ● | 47-E2-20-20 |
| 20 | 25 | 60 | ● | 47-E2-20-25 |
| 25 | 8 | 50 | ● | 47-E2-25-08 |
| 25 | 10 | 50 | ● | 47-E2-25-10 |
| 25 | 12 | 50 | ● | 47-E2-25-12 |
| 25 | 16 | 50 | ● | 47-E2-25-16 |
| 25 | 20 | 50 | ● | 47-E2-25-20 |
| 25 | 25 | 60 | ● | 47-E2-25-25 |
| 30 | 8 | 60 | ● | 47-E2-30-08 |
| 30 | 10 | 60 | ● | 47-E2-30-10 |
| 30 | 12 | 60 | ● | 47-E2-30-12 |
| 30 | 16 | 60 | ● | 47-E2-30-16 |
| 30 | 20 | 60 | ● | 47-E2-30-20 |
| 30 | 25 | 60 | ● | 47-E2-30-25 |
| 30 | 32 | 75 | ● | 47-E2-30-32 |
| 40 | 6 | 75 | ● | 47-E2-40-06 |
| 40 | 8 | 75 | ● | 47-E2-40-08 |
| 40 | 10 | 75 | ● | 47-E2-40-10 |
| 40 | 12 | 75 | ● | 47-E2-40-12 |
| 40 | 16 | 75 | ● | 47-E2-40-16 |
| 40 | 20 | 75 | ● | 47-E2-40-20 |
| 40 | 25 | 75 | ● | 47-E2-40-25 |
| 40 | 32 | 75 | ● | 47-E2-40-32 |
| 40 | 40 | 90 | ● | 47-E2-40-40 |
| 40 | 50 | 90 | ● | 47-E2-40-50 |
| 50 | 10 | 75 | ● | 47-E2-50-10 |
| 50 | 12 | 90 | ● | 47-E2-50-12 |
| 50 | 16 | 90 | ● | 47-E2-50-16 |
| 50 | 20 | 90 | ● | 47-E2-50-20 |
| 50 | 25 | 90 | ● | 47-E2-50-25 |
| 50 | 32 | 90 | ● | 47-E2-50-32 |
| 50 | 40 | 90 | ● | 47-E2-50-40 |
| 50 | 50 | 100 | ● | 47-E2-50-50 |
| 60 | 12 | 90 | ● | 47-E2-60-12 |
| 60 | 16 | 90 | ● | 47-E2-60-16 |
| 60 | 20 | 90 | ● | 47-E2-60-20 |
| 60 | 25 | 90 | ● | 47-E2-60-25 |
| 60 | 32 | 90 | ● | 47-E2-60-32 |
| 60 | 40 | 90 | ● | 47-E2-60-40 |
| 60 | 50 | 100 | ● | 47-E2-60-50 |

**Beliebige Innendurchmesser, Zwischengrößen, Zollmaße etc.
lieferbar auf Anfrage!**
*Any internal diameter, intermediary bores, inch bores etc.
available upon request!*

Typ E3, Spannzangenfutter OZ, für Spannzangen DIN 6388
Type E3, collet chucks OZ, for collets DIN 6388



| d1 mm | d3 mm | OZ | Spannbereich/ Clamping range | b mm | Art.-Nr./ Order no |
|----------|----------|-------|---------------------------------|---------|-----------------------|
| 16 | 40 | 415 E | 2-16 | 65 | 47-E3-16-16 |
| 20 | 50 | 415 E | 2-16 | 57 | 47-E3-20-16 |
| 20 | 50 | 415 E | 2-20 | 62 | 47-E3-20-20 |
| 25 | 58 | 415 E | 2-16 | 57 | 47-E3-25-16 |
| 30 | 68 | 462 E | 2-25 | 75 | 47-E3-30-25 |
| 40 | 83 | 462 E | 2-25 | 75 | 47-E3-40-25 |
| 40 | 83 | 467 E | 4-32 | 90 | 47-E3-40-32 |
| 50 | 98 | 462 E | 2-25 | 75 | 47-E3-50-25 |
| 50 | 98 | 467 E | 4-32 | 90 | 47-E3-50-32 |
| 60 | 123 | 467 E | 4-32 | 90 | 47-E3-60-32 |

Typ E4, Spannzangenfutter ER, für Spannzangen DIN 6499
Type E4, collet chucks ER, for collets DIN 6499

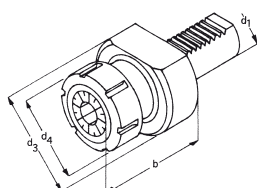

| d1 mm | d3 mm | ER | Spannbereich/ Clamping range | b mm | Art.-Nr./ Order no |
|----------|----------|-------|---------------------------------|---------|-----------------------|
| 16 | 40 | ER 16 | 1-10 | 40 | 47-E4-16-16 |
| 16 | 40 | ER 20 | 1-13 | 44 | 47-E4-16-20 |
| 20 | 50 | ER 16 | 1-10 | 40 | 47-E4-20-16 |
| 20 | 50 | ER 25 | 1-16 | 54 | 47-E4-20-25 |
| 25 | 58 | ER 25 | 1-16 | 57 | 47-E4-25-25 |
| 25 | 58 | ER 32 | 2-20 | 62 | 47-E4-25-32 |
| 30 | 68 | ER 25 | 1-16 | 57 | 47-E4-30-25 |
| 30 | 68 | ER 32 | 2-20 | 62 | 47-E4-30-32 |
| 30 | 68 | ER 40 | 2-25 | 70 | 47-E4-30-40 |
| 40 | 83 | ER 25 | 1-16 | 70 | 47-E4-40-25 |
| 40 | 83 | ER 32 | 2-20 | 84 | 47-E4-40-32 |
| 40 | 83 | ER 40 | 2-25 | 75 | 47-E4-40-40 |
| 50 | 98 | ER 32 | 2-20 | 84 | 47-E4-50-32 |
| 50 | 98 | ER 40 | 2-25 | 90 | 47-E4-50-40 |
| 60 | 123 | ER 40 | 2-25 | 75 | 47-E4-60-40 |

Typ E2S, Werkzeughalter geschlitzt, schwingungsarm
Type E2S, toolholder with split, reduced vibration

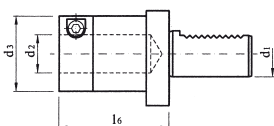

| Typ/ Type | d1 mm | d2 mm | d3 mm | l6 mm | Art.-Nr./ Order no |
|--------------|----------|----------|----------|----------|-----------------------|
| 30 x 6 | 30 | 6 | 30 | 57 | 47-E2S-30-06 |
| 30 x 8 | 30 | 8 | 30 | 57 | 47-E2S-30-08 |
| 30 x 10 | 30 | 10 | 36 | 57 | 47-E2S-30-10 |
| 30 x 12 | 30 | 12 | 36 | 57 | 47-E2S-30-12 |
| 30 x 16 | 30 | 16 | 40 | 57 | 47-E2S-30-16 |
| 30 x 20 | 30 | 20 | 44 | 57 | 47-E2S-30-20 |
| 30 x 25 | 30 | 25 | 49 | 72 | 47-E2S-30-25 |
| 30 x 32 | 30 | 32 | 56 | 72 | 47-E2S-30-32 |
| 40 x 10 | 40 | 10 | 36 | 62 | 47-E2S-40-10 |
| 40 x 12 | 40 | 12 | 36 | 62 | 47-E2S-40-12 |
| 40 x 16 | 40 | 16 | 40 | 62 | 47-E2S-40-16 |
| 40 x 20 | 40 | 20 | 44 | 62 | 47-E2S-40-20 |
| 40 x 25 | 40 | 25 | 49 | 77 | 47-E2S-40-25 |
| 40 x 32 | 40 | 32 | 56 | 77 | 47-E2S-40-32 |
| 40 x 40 | 40 | 40 | 64 | 77 | 47-E2S-40-40 |
| 50 x 20 | 50 | 20 | 44 | 90 | 47-E2S-50-20 |
| 50 x 25 | 50 | 25 | 49 | 90 | 47-E2S-50-25 |
| 50 x 32 | 50 | 32 | 56 | 90 | 47-E2S-50-32 |
| 50 x 40 | 50 | 40 | 64 | 90 | 47-E2S-50-40 |

Typ F, Morsekegelaufnahme
Type F, Morse taper holder

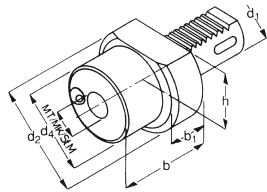

| d1 mm | MK/ MT | h mm | d2 mm | b mm | | Art.-Nr./ Order no |
|----------|-----------|---------|----------|---------|---|-----------------------|
| 20 | 1 | 23 | 50 | 22 | ● | 47-F20-1 |
| 20 | 2 | 23 | 50 | 90 | ● | 47-F20-2 |
| 25 | 1 | 25 | 58 | 22 | ● | 47-F25-1 |
| 25 | 2 | 25 | 58 | 46 | ● | 47-F25-2 |
| 30 | 1 | 28 | 68 | 27 | ● | 47-F30-1 |
| 30 | 2 | 28 | 68 | 36 | ● | 47-F30-2 |
| 30 | 3 | 28 | 68 | 66 | ● | 47-F30-3 |
| 40 | 1 | 32,5 | 83 | 36 | ● | 47-F40-1 |
| 40 | 2 | 32,5 | 83 | 36 | ● | 47-F40-2 |
| 40 | 3 | 32,5 | 83 | 50 | ● | 47-F40-3 |
| 40 | 4 | 32,5 | 83 | 80 | ● | 47-F40-4 |
| 50 | 2 | 35 | 98 | 36 | ● | 47-F50-2 |
| 50 | 3 | 35 | 98 | 45 | ● | 47-F50-3 |
| 50 | 4 | 35 | 98 | 55 | ● | 47-F50-4 |
| 50 | 5 | 35 | 98 | 68 | ● | 47-F50-5 |
| 60 | 3 | 42,5 | 123 | 36 | ● | 47-F60-3 |
| 60 | 4 | 42,5 | 123 | 50 | ● | 47-F60-4 |
| 60 | 5 | 42,5 | 123 | 81 | ● | 47-F60-5 |

Stangengreifer
Bar puller

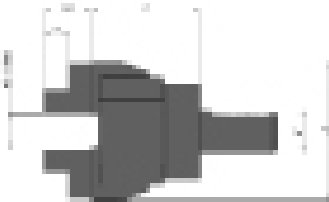

- Für zwei Spannungsbereiche
- Mit Wendebacken

- For two clamping ranges
- With reversible clamping jaws

| d1 mm | Spannber. 1/ Clamp.range 1 | Spannber. 2/ Clamp.range 2 | L1 mm | L2 mm | L3 mm | L4 mm | | Art.-Nr./ Order no |
|-------------------------------------------------------------------------|-------------------------------|-------------------------------|----------|----------|----------|----------|---|-----------------------|
| 20 | 6-45 | 45-100 | 77 | 99 | 34 | 18 | ● | 47-SGF20 |
| 30 | 6-45 | 45-100 | 77 | 99 | 34 | 18 | ● | 47-SGF30 |
| Zyl. 32 | 6-45 | 45-100 | 77 | 99 | 34 | 18 | ● | 47-SGF32Z |
| 40 | 6-56 | 56-110 | 79 | 111 | 34 | 18 | ● | 47-SGF40 |
| 50 | 6-56 | 56-110 | 79 | 111 | 34 | 18 | ● | 47-SGF50 |
| Satz Ersatzbacken für Stangengreifer / Set of spare jaws for bar puller | | | | | | | | ● 47-SGF-B |

Kurzbohrfutter VDI

Universal drill chucks VDI

DIN 69880 (VDI), mit Kühlmitteldüsen*

DIN 69880 (VDI), with coolant nozzles*

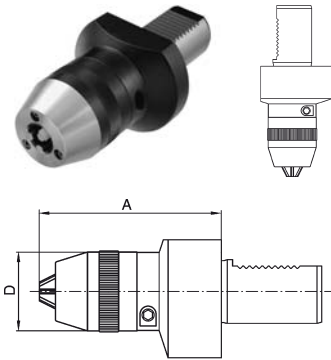

| VDI | Spannweite/ Capacity mm | A mm | D mm | | Art.-Nr./ Order no |
|------|-------------------------------|---------|---------|---|-----------------------|
| 16** | 1-10 | 41 | 50 | ▶ | 82-341016 |
| 20** | 1-10 | 41 | 50 | ▶ | 82-341020 |
| 30 | 1-13 | 87 | 50 | ● | 82-341330 |
| 30 | 1-16 | 92 | 55 | ● | 82-341630 |
| 40 | 1-13 | 88 | 50 | ● | 82-341340 |
| 40 | 1-16 | 93 | 55 | ● | 82-341640 |
| 50 | 1-16 | 101,5 | 55 | ▶ | 82-341650 |

* Lieferbar auch mit Innenkühlung / Available also with internal coolant supply

** Spannung durch den Schaft / Clamping by collar screw

Mitlaufende Zentrierspitze

Revolving tailstock centre

Gefedert, mit VDI-Schaft

Spring mounted, with VDI-shank

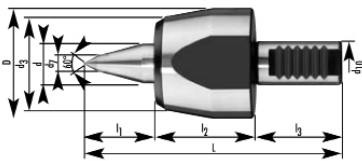

Verwendungszweck:

Speziell für Einsatz auf CNC-Drehmaschinen für die automatische Komplettbearbeitung mit zwei Schlitzen

Besondere Merkmale:

Gefedert, hoch belastbar bei hoher Drehzahl. Kräftige Bauweise und Lagerung.

Range of application:

Especially for the use for CNC lathes for the automatical lathe tooling and finishing with two slides.

Special characteristics:

Spring mounted, highly capable of bearing at high revolutions. Strong construction and bearing.

| Typ/ Type | d10 mm | d mm | d1 mm | d7 mm | D mm | l1 mm | l2 mm | l3 mm | L mm | Federweg/ Travelstroke max. | P bei 1mm in N | P max. N | Rund.fehl./ Runout mm | Werkst./ Workp. kg | Max. Drehzahl/ Max. rev. | Art.-Nr./ Order no |
|--------------|-----------|---------|----------|----------|---------|----------|----------|----------|---------|-----------------------------------|-------------------|-------------|-----------------------------|--------------------------|--------------------------------|-----------------------|
| 60°/30° | 20 | 18 | 41 | 6 | 50 | 31 | 42 | 40 | 113 | 2,8 | 480 | 1400 | 0,005 | 180 | 7000 | ▶ 47-MZ-20 |
| 60°/30° | 30 | 22 | 47 | 11 | 67 | 37 | 51 | 55 | 143 | 3,12 | 800 | 3100 | 0,005 | 400 | 6300 | ▶ 47-MZ-30 |
| 60°/30° | 40 | 32 | 56 | 16 | 83 | 48 | 63 | 63 | 174 | 3,2 | 1550 | 5600 | 0,005 | 1000 | 5300 | ▶ 47-MZ-40 |

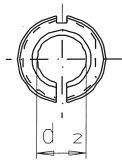
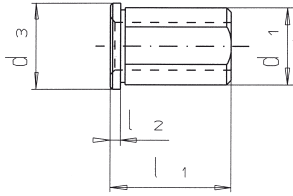

Reduzierbuchsen RZ, geschlitzt
Reduction sleeves RZ, slotted

| d1 mm | d2 mm | d3 mm | l1 mm | l2 mm | | Art.-Nr./ Order no |
|----------|----------|----------|----------|----------|---|-----------------------|
| 20 | 8 | 24 | 50 | 4 | ● | 47-RZ-20-08 |
| 20 | 10 | 24 | 50 | 4 | ● | 47-RZ-20-10 |
| 20 | 12 | 24 | 50 | 4 | ● | 47-RZ-20-12 |
| 20 | 14 | 24 | 50 | 4 | ● | 47-RZ-20-14 |
| 20 | 15 | 24 | 50 | 4 | ● | 47-RZ-20-15 |
| 20 | 16 | 24 | 50 | 4 | ● | 47-RZ-20-16 |
| 25 | 8 | 29 | 50 | 4 | ● | 47-RZ-25-08 |
| 25 | 10 | 29 | 50 | 4 | ● | 47-RZ-25-10 |
| 25 | 12 | 29 | 50 | 4 | ● | 47-RZ-25-12 |
| 25 | 14 | 29 | 50 | 4 | ● | 47-RZ-25-14 |
| 25 | 15 | 29 | 50 | 4 | ● | 47-RZ-25-15 |
| 25 | 16 | 29 | 50 | 4 | ● | 47-RZ-25-16 |
| 25 | 18 | 29 | 50 | 4 | ● | 47-RZ-25-18 |
| 25 | 20 | 29 | 50 | 4 | ● | 47-RZ-25-20 |
| 32 | 8 | 36 | 60 | 4 | ● | 47-RZ-32-08 |
| 32 | 10 | 36 | 60 | 4 | ● | 47-RZ-32-10 |
| 32 | 12 | 36 | 60 | 4 | ● | 47-RZ-32-12 |
| 32 | 14 | 36 | 60 | 4 | ● | 47-RZ-32-14 |
| 32 | 15 | 36 | 60 | 4 | ● | 47-RZ-32-15 |
| 32 | 16 | 36 | 60 | 4 | ● | 47-RZ-32-16 |
| 32 | 18 | 36 | 60 | 4 | ● | 47-RZ-32-18 |
| 32 | 20 | 36 | 60 | 4 | ● | 47-RZ-32-20 |
| 32 | 25 | 36 | 60 | 4 | ● | 47-RZ-32-25 |
| 40 | 10 | 44 | 75 | 4 | ● | 47-RZ-40-10 |
| 40 | 12 | 44 | 75 | 4 | ● | 47-RZ-40-12 |
| 40 | 14 | 44 | 75 | 4 | ● | 47-RZ-40-14 |
| 40 | 15 | 44 | 75 | 4 | ● | 47-RZ-40-15 |
| 40 | 16 | 44 | 75 | 4 | ● | 47-RZ-40-16 |
| 40 | 18 | 44 | 75 | 4 | ● | 47-RZ-40-18 |
| 40 | 20 | 44 | 75 | 4 | ● | 47-RZ-40-20 |
| 40 | 25 | 44 | 75 | 4 | ● | 47-RZ-40-25 |
| 40 | 32 | 44 | 75 | 4 | ● | 47-RZ-40-32 |
| 50 | 20 | 54 | 75 | 4 | ● | 47-RZ-50-20 |
| 50 | 25 | 54 | 75 | 4 | ● | 47-RZ-50-25 |
| 50 | 32 | 54 | 75 | 4 | ● | 47-RZ-50-32 |
| 50 | 40 | 54 | 75 | 4 | ● | 47-RZ-50-40 |
| 60 | 25 | 64 | 75 | 4 | ● | 47-RZ-60-25 |
| 60 | 32 | 64 | 75 | 4 | ● | 47-RZ-60-32 |
| 60 | 40 | 64 | 75 | 4 | ● | 47-RZ-60-40 |
| 60 | 50 | 64 | 75 | 4 | ● | 47-RZ-60-50 |

Prüfdorne
Test mandrel

DIN 69880
DIN 69880

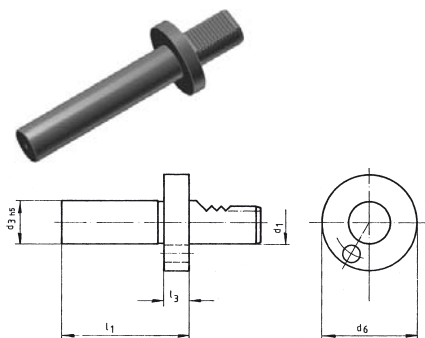

| d1 mm | d3 mm | d6 mm | l1 mm | l3 mm | | Art.-Nr./ Order no |
|----------|----------|----------|----------|----------|---|-----------------------|
| 16 | 30 | 40 | 120 | 15 | ▶ | 47-PD-16-30 |
| 20 | 40 | 50 | 150 | 15 | ▶ | 47-PD-20-40 |
| 25 | 40 | 58 | 150 | 15 | ▶ | 47-PD-25-40 |
| 30 | 40 | 68 | 200 | 15 | ● | 47-PD-30-40 |
| 40 | 40 | 83 | 200 | 15 | ● | 47-PD-40-40 |
| 50 | 40 | 98 | 200 | 15 | ● | 47-PD-50-40 |
| 60 | 40 | 123 | 200 | 15 | ▶ | 47-PD-60-40 |

Schutzstopfen
Protective plug

Schutzstopfen Z2, Stahl
Protective plug Z2, steel



| d mm | D mm | l mm | | Art.-Nr./ Order no |
|---------|---------|---------|---|-----------------------|
| 16 | 40 | 13 | ● | 47-Z2-16S |
| 20 | 50 | 16 | ● | 47-Z2-20S |
| 25 | 58 | 16 | ● | 47-Z2-25S |
| 30 | 68 | 16 | ● | 47-Z2-30S |
| 40 | 83 | 20 | ● | 47-Z2-40S |
| 50 | 98 | 20 | ● | 47-Z2-50S |
| 60 | 123 | 20 | ● | 47-Z2-60S |

Schutzstopfen Z2, Kunststoff
Protective plug Z2, plastic



| d mm | D mm | l mm | | Art.-Nr./ Order no |
|---------|---------|---------|---|-----------------------|
| 16 | 40 | 13 | ● | 47-Z2-16K |
| 20 | 50 | 16 | ● | 47-Z2-20K |
| 25 | 58 | 16 | ● | 47-Z2-25K |
| 30 | 68 | 16 | ● | 47-Z2-30K |
| 40 | 83 | 20 | ● | 47-Z2-40K |
| 50 | 98 | 20 | ● | 47-Z2-50K |
| 60 | 123 | 20 | ● | 47-Z2-60K |